



U46S

QUICK START GUIDE

Induction drone only indoor flight

Note

- ▲ This product is suitable for users over 14 years old.
 - ▲ Stay away from the rotating propeller
 - ▲ Read the "important statement and safety guidelines" carefully.
- <https://udirc.com/disclaimer-and-safety-instructions>



Li-Po Battery Disposal & Recycling

Wasted Lithium-Polymer batteries must not be placed with household trash. Please contact local environmental or waste agency or the supplier of your model or your nearest Li-Po battery recycling center.



Important Notice

Our company's products are improving all the time, design and specifications are subject to change without notice. All the information in this manual has been carefully checked to ensure accuracy, if any printing errors, our company reserve the final interpretation right.

Ready before flight

Drone Overview

TOP

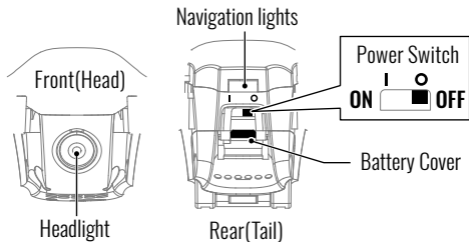
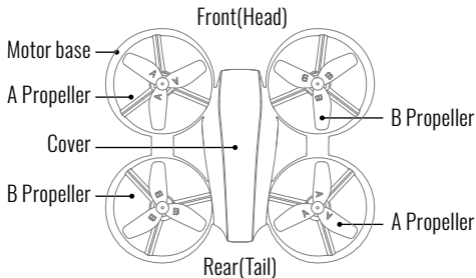

Drone Battery Charger

Connect drone battery with included USB charger cable, and then connect to other USB output port (Output: 5V = 2A). The USB charger indicator light will red when charging and the light turns green when fully charged.

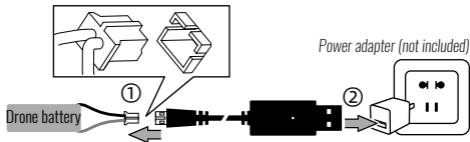

Warning: Must be supervised while charging
Please use the included USB charging cable and make sure it is properly connected.

Drone Battery Installation

Install the batteries in order, and remove them in reverse.

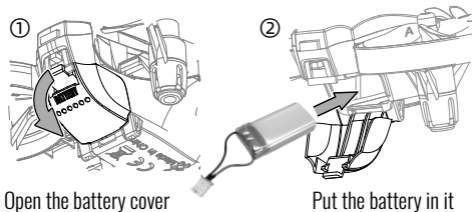

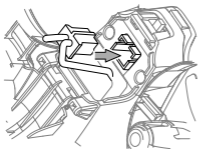

- ③ Plug the battery plug into the body socket and close the battery cover.

Transmitter preparation

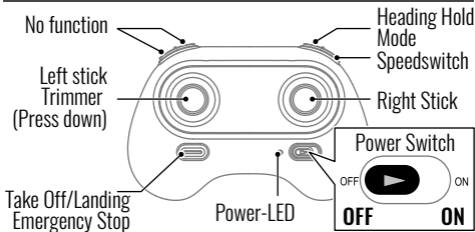

Control stick operation

Left stick

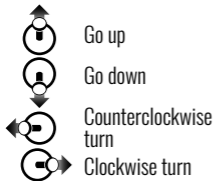

Right stick

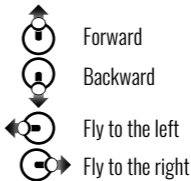

Battery Installation

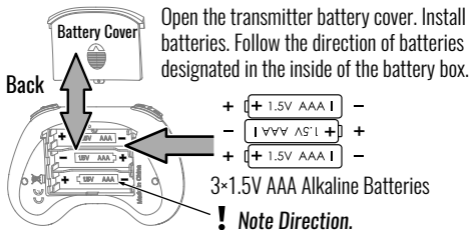

Flight Operations

Drone preparation

! Turn me on in a room with lots of space(Suggest $\geq 16m^2$)
Turn on the power of the drone, the navigation lights changes from flash quickly to flash slowly. It indicating to enter frequency state.

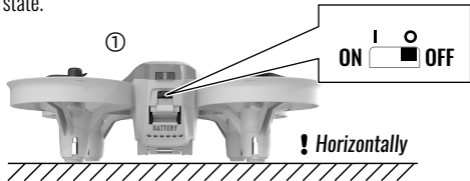



Turn on the power on the transmitter, the Power-LED will flash quickly.

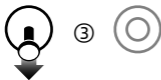

Pull the left stick to the lowest position and let go, the Power-LED changes from flash to keep long bright. The navigations will keep long bright. It indicating frequency pairing successful.

Take off

Press the "  " button, the drone will automatically rises and flies at an altitude of about 1.2 meters.

Landing

During the flight, press the "  " button, the drone will land slowly until landing.

! *Don't operate the left stick during landing, otherwise the current command will automatically fail.*

Emergency Stop: During the flight, press "  " button for about 2 seconds, the transmitter will sound "di.di..." and the drone crashes directly.

Tip: Do not use the emergency stop function unless in emergency situation.

Heading Hold Mode



Heading Hold Mode means that the user can operate the drone without having to distinguish directions.

Start: Press the "  " button, the transmitter will sound "didi" to enter the Heading Hold Mode.

Off: Press again, the transmitter will sound "dididi" to exit the Heading Hold Mode.

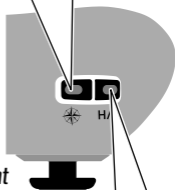
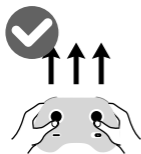

! *Must be ensure that the drone's front is consistent with the pilot's front.*

Speed mode switch

Medium speed default

Press the "H/L" button, the transmitter will sound "di.di.di", to enter High Speed Mode "H". Press again, the transmitter will sound "di", to enter Low Speed Mode "L". Press again, the transmitter will sound "di.di", to enter Middle Speed Mode "M".

Flying Trimmer

↓
Press down



Forward / Backward Trimmer

During the flight, if the drone tilts forward, press down the left stick in the center button, and push the right stick backwards. Otherwise push forwards.

↓
Press down



Left / right side flying trimmer

During the flight, if the drone tilts to left, then press down the left stick in the center button and push the right stick to right to adjust. Otherwise push to left.

← →
Press down



Left / right turning trimmer

During the flight, if the drone head rotates to left, then press down the left stick in the center button and push the left stick to right. Otherwise push to left.

Calibration (Use when the flight abnormal)

After successful frequency alignment, the right stick is pushed to the lower right corner by 45°, and the drone navigation lights turns to keep bright after quick flashing, indicating that the gyroscope has been calibrated. Release the right stick.



Tips: Restart the power of transmitter and the drone to enter the calibration after the frequency pairing is successful.

Low Battery Alarm

Transmitter: When the power of the transmitter is nearly exhausted, the Power-LED will continue flash. At this time, you must return back to replace the battery soon.

Drone: When the drone in low battery, the navigation lights will continue to "flash and stop", the drone must return home at this time.

Stuck Protection

- 1) When the propellers get stuck, then activate stuck protection function and the motors stop running.
- 2) Pull down the left stick to the lowest position and then go back to the center, stuck protection will be released and the drone can fly again.

ATTENTION

- 1) *Switching sequence. At first, turn on the power of the drone, then turn on the power of the transmitter. After the end, turn off the power of the drone first, and then turn off the power of the transmitter.*
- 2) *Improper operation caused the crash. It is necessary to check and confirm the connection of the motor, propeller or battery of the drone and the damage degree, so that the drone can fly again. If there is damaged, please replace the new accessories or prone to accident.*

Propeller Replacement

Disassembly

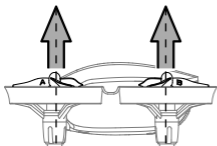

Hold the propeller vertically and then pull the propeller out.

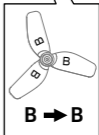
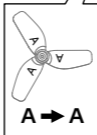
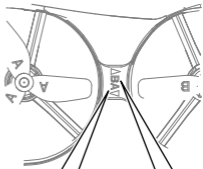

Installation

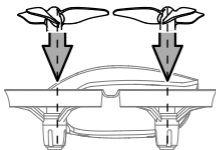

Mount propeller aim the central shaft of the motor and press down.

- ! The letter on the propeller corresponds to the letter mark on the motor base. Propeller must be installed correctly, otherwise cannot fly.



<https://udirc.com/disclaimer-and-safety-instructions>

FCC Note

This equipment has been tested and found to comply with the limits for a Class B digital device, pursuant to Part 15 of the FCC Rules. These limits are designed to provide reasonable protection against harmful interference in a residential installation. This equipment generates uses and can radiate radio frequency energy and, if not installed and used in accordance with the instructions, may cause harmful interference to radio communications. However, there is no guarantee that interference will not occur in a particular installation. If this equipment does cause harmful interference to radio or television reception, which can be determined by turning the equipment off and on, the user is encouraged to try to correct the interference by one or more of the following measures:

- *Reorient or relocate the receiving antenna.*
- *Increase the separation between the equipment and receiver.*
- *Connect the equipment into an outlet on a circuit different from that to which the receiver is connected.*

WARNING: Changes or modifications not expressly approved by the party responsible for compliance could void the user's authority to operate the equipment.

The equipment may generate or use radio frequency energy. Changes or modifications to this equipment may cause harmful interference unless the modifications are expressly approved in the instruction manual. Modifications not authorized by the manufacturer may void user's authority to operate this device.

This device complies with Part 15 of the FCC Rules. Operation is subject to the following two conditions:

- (1) This device may not cause harmful interference.
- (2) This device must accept any interference received, including interference that may cause undesired operation.

FCC Radiation Exposure Statement

The device has been evaluated to meet general RF exposure requirement. The device can be used in portable exposure condition with out restriction.

WARNING



DANGER!

Only suitable for age 14+

Warning:

The product should only be used by adults and children over 14 years.

Adult supervision is required for children under 14 years.

Hinweis:

Dieses Produkt ist für die Erwachsene und die Kinder ab 14 Jahren.

Die Kinder unter 14 Jahren müssen von Erwachsenen beaufsichtigt werden.

Avertissement:

Ce produit est destiné aux adultes et aux enfants de plus de 14 ans.

Les enfants de moins de 14 ans doivent être surveillés par des adultes.

Avvertimento:

Questo prodotto è destinato all'uso per i adulti e bambini di età superiore ai 14 anni.

I bambini di età inferiore ai 14 anni devono essere sorvegliati da un adulto.

Advertencia:

Este producto es para adultos y niños mayores de 14 años.

Los niños menores de 14 años deben ser supervisados por adultos.

警告:

この製品は、大人と14歳以上の子供には使用対象です。

14歳未満の子供は大人の監視が必要です。



Manufacturer: SHANTOU CITY CHENGHAI UDIRC TOYS CO., LTD

Address: Guangfeng Industrial Zone, Guangyi Street, Chenghai District, Shantou City, Guangdong Province, CN

Model: U46S

Manufacture time:

MADE IN CHINA